

**LAND USE BYLAW AMENDMENT  
SCHEDULE 'A'**

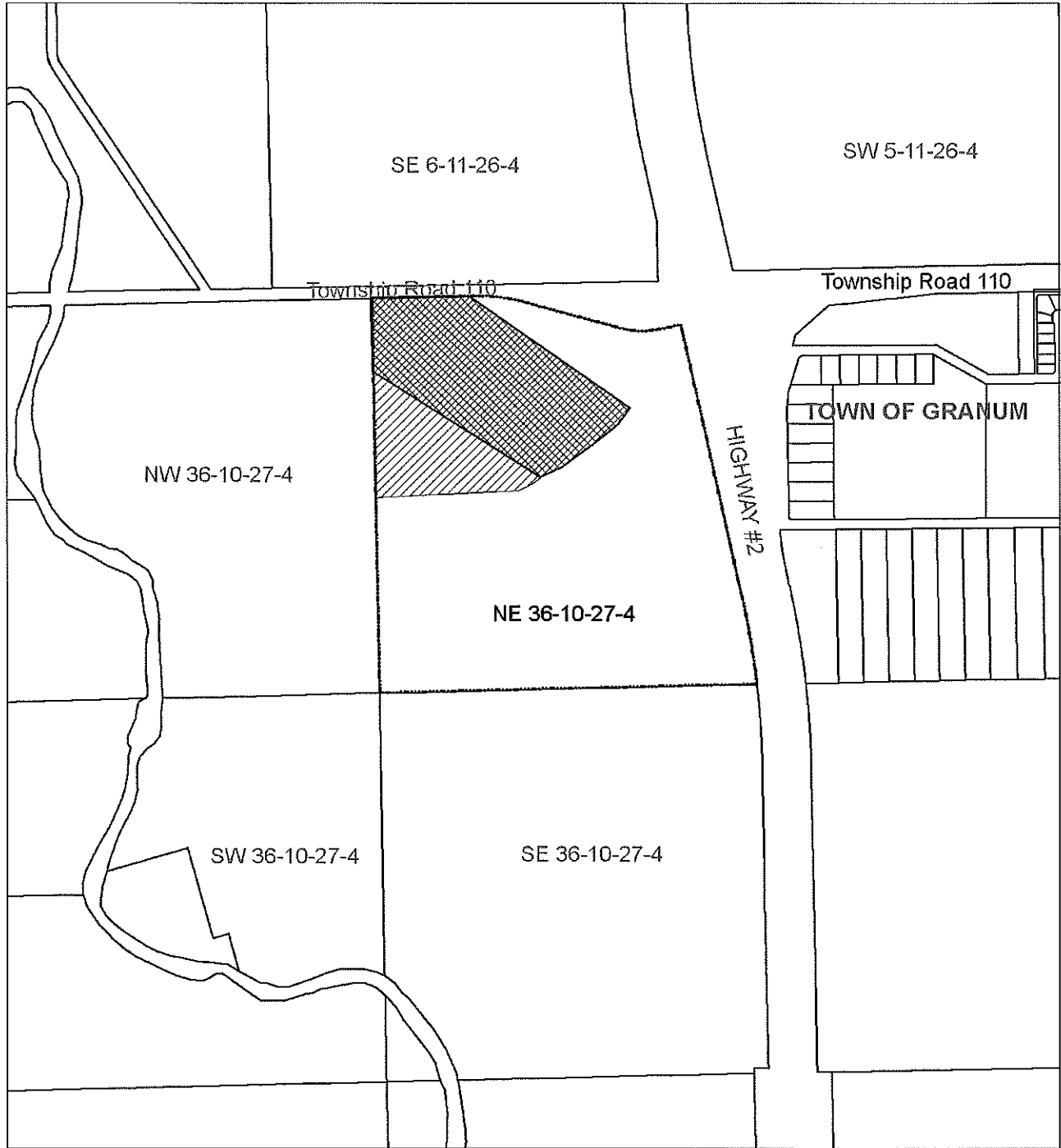

**LAND USE AMENDMENT FROM 'RURAL GENERAL - RG' TO '  
TO 'RR' & 'RC' (SEE LEGEND)**

Portion of NE 36-10-27-4

**LEGEND**



'Rural Commercial - RC'



'Rural Recreational - RR'



NOT TO SCALE



PREPARED BY: DEVELOPMENT DEPARTMENT

DATE: MAY 12, 2010